

TOWN PLANNING SCHEME AHMEDABAD NO-5
(CITYWALL IMPROVEMENT)

SECTION - J ASTODIA GATE TO RAIPUR GATE

FINAL SCHEME PLAN NO - 4

SCALE: 40 FEET TO AN INCH.
(1 CM = 4.80 METRS.)

NOTE:-

- (1) BOUNDARY OF SCHEME SHOWN THUS -
- (2) BOUNDARY OF FINAL PLOTS SHOWN THUS -

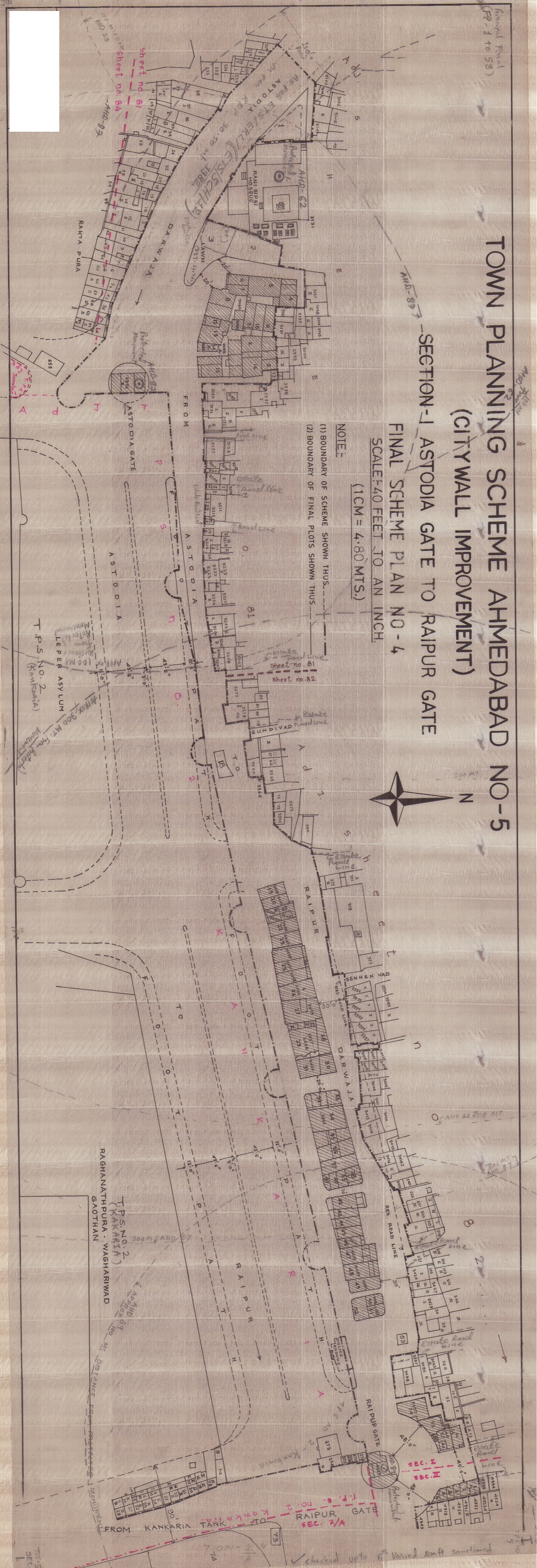

Final Final
FP-1 to 58

1982

Sheet no. 81
Sheet no. 84

T.P.S. NO. 2
(KAKARIA)
RAGHANATHPURA - WAGHARIWAD
GAOTHAN

FROM KANKARIA TANK TO RAIPUR GATE

checked upto 6th Varied staff sanctioned